



Part Number: MJK-1040

Contents: 4 Main Jets(165, 167.5, 170 & 175), 3 Pilot Jets(25, 27.5, 30), 4 Needle Jet Shims & 1 Special Float Needle

READ AND UNDERSTAND THESE INSTRUCTIONS COMPLETELY BEFORE BEGINNING INSTALLATION.

**THIS INFORMATION IS PROVIDED AS SUGGESTIONS ONLY, MPI MAKES NO
GUARANTEES AND ACCEPTS NO LIABILITIES; IMPLIED OR STATED. USE THIS
INFORMATION AT YOUR OWN RISK.**

Refer to Supercharger Installation instructions for Jetting Instructions.

1. Replace OEM Float Needle with the special High Performance Float Needle. The OEM Needle is not resilient to many of the newer fuel additives. The new needle is more compatible with fuel additives and also provides a higher pop-off pressure. That is it is capable of closing the bowl fill nozzle under higher pressure than the OEM needle.
2. Select a same main jet from the choices listed in the Supercharger Installation Instructions.
Possible starting points:
 - a. With OEM exhaust, at 0 to 3000 feet elevation and warm temps a 167.5 main
 - b. With OEM exhaust, at 3500 to 5500 feet elevation and warm temps a 165 main
 - c. At cooler temps say, below 40F, increase main jet size by 2.5
 - d. Some exhaust may require a slight jet increase 2.5 to 5 in numerical size.
 - e. **MANY AFTER MARKET EXHAUST SYSTEMS ARE WORSE THAN STOCK.** A reasonable rule of thumb is; “I your ears are NOT bleeding, the aftermarket system is too restrictive”. We have **NOT** found a quiet (or even close to quiet) aftermarket system that has adequate flow for the supercharger.
3. Select the proper pilot jet. Typically a 30 or 27.5 at low altitude and a 25 at higher altitudes.
4. The needle typically needs to be raised or richened. Refer to the Supercharger Installation Instructions for the proper procedure. On units with a non-adjustable needle there will only be 1 groove for the e-clip, adjustable needles have 3 grooves. On adjustable needles, move the e-clip to the bottom groove (the groove closest to the pointy end of the needle). Move the thick metal washer to the bottom side of the e-clip so that there are 2 metal washers plus the plastic spacer below the e-clip and only the spring and cap above the e-clip. On non-adjustable needles use the same procedure but in addition to the plastic spacer and the 2 metal OEM washers add an additional 1mm of washers (not supplied) or replace the needle with an adjustable one. **WASHERS PROVIDED ARE 0.5MM Thick. 4 washers are included.**



SUPERCHARGED RHINO CARB NEEDLE SETUP

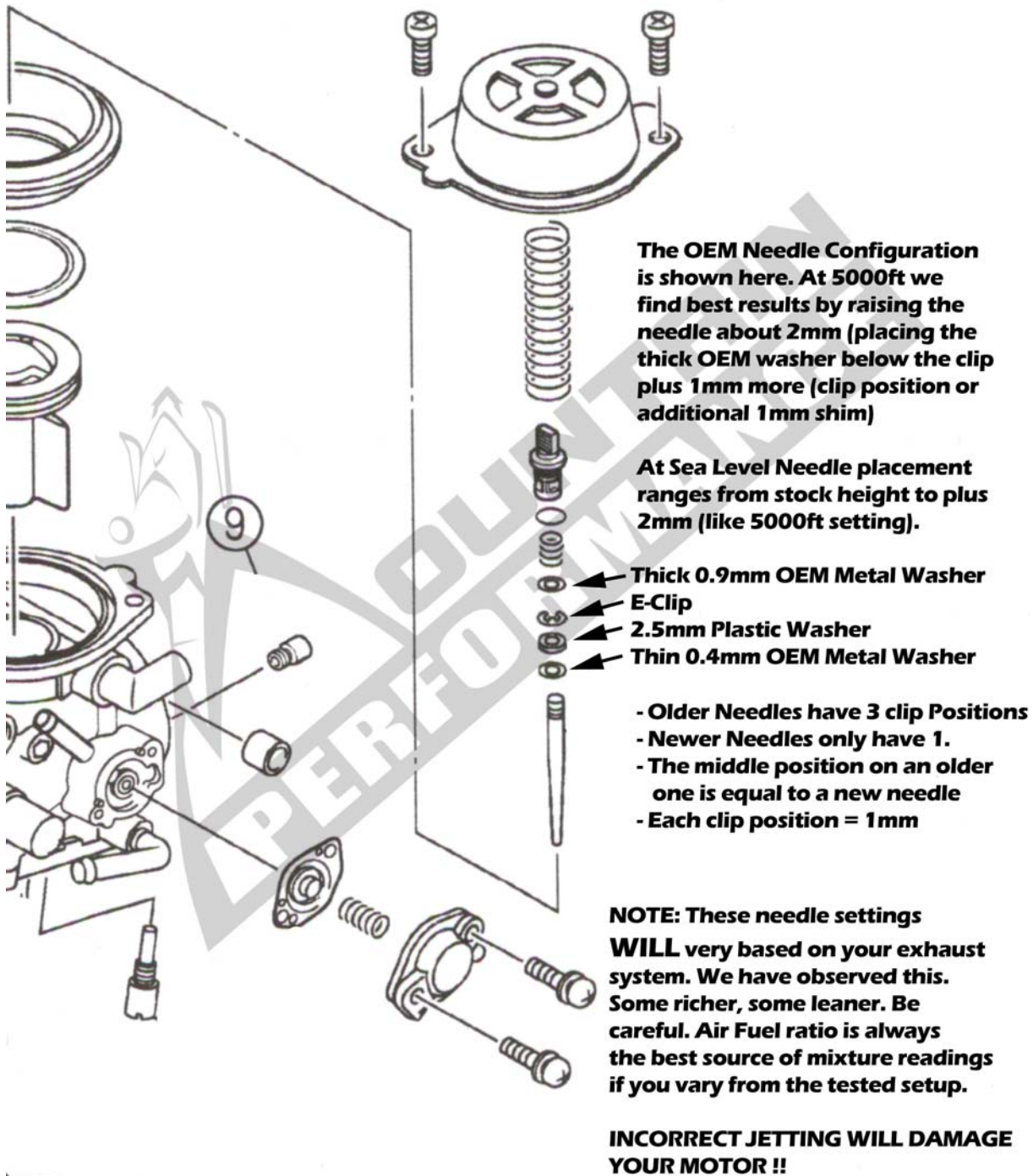



Flat Slide™ Carburetor Float Height Measurement - All Liquid Cooled Models

To check the float height on Flat Slide™ carburetors, measure the distance between the carburetor body and the highest point of the float.

NOTE: Rotate the carburetor slightly so the float arm is resting on the needle valve without exerting pressure on it.

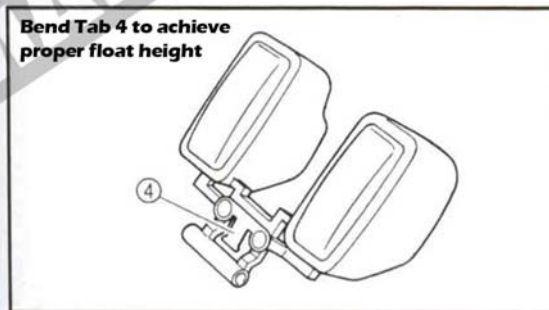
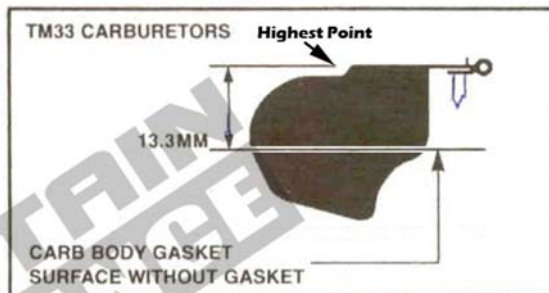
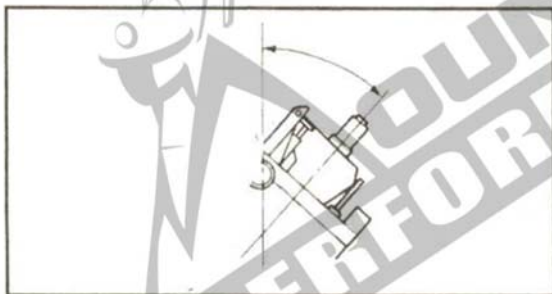

SUPERCHARGED RHINO FLOAT ADJUSTMENT

- 1) Stock Float Height is 13.3mm
- 2) If Flood over is experienced (typically seen under deceleration, hard braking, hard cornering and rough terrain) the float height may be adjusted to 15mm. **NOTE:** If this causes surging or missing under WOT, the float level must be adjusted back to 14 or 13mm. (All carbs differ slightly).